

**NOTICE!!**

**These documents have been scanned!**

**Do not place un-scanned documents beneath this notice!**

**Do not remove this notice from this file!**

GPO Jacket No. 560-102  
Print Order 61540  
Rise Business Services, LLC  
Job=AZ15 5/10/2019



Box Number= AZ15032



Claim Begin-End: AMC429020-AMC429020

1 Initial Receipt



AZ15032-9

AMC428906-AMC429539

**AMC#**

**DATE CLOSED**

**REMARKS**

429020

| AMC#   | DATE CLOSED | REMARKS |
|--------|-------------|---------|
| 429020 |             |         |
|        |             |         |
|        |             |         |
|        |             |         |
|        |             |         |
|        |             |         |
|        |             |         |
|        |             |         |
|        |             |         |
|        |             |         |
|        |             |         |
|        |             |         |
|        |             |         |
|        |             |         |
|        |             |         |
|        |             |         |
|        |             |         |
|        |             |         |
|        |             |         |
|        |             |         |
|        |             |         |
|        |             |         |
|        |             |         |
|        |             |         |

NO WARRANTY IS MADE BY BLM  
FOR USE OF THE DATA FOR  
PURPOSES NOT INTENDED BY BLM

**United States Department of the Interior**  
**Bureau of Land Management**  
 LANDS/RECREATION & PLANNING  
 ONE N CENTRAL AVE  
 PHOENIX, AZ 85004 -2203  
 Phone: 602-417-9200

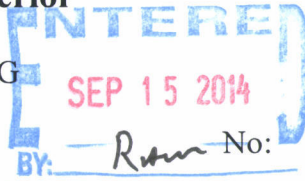

Receipt

3122111

|  |  |
|--|--|
| <b>Transaction #:</b> 3213977  |  |
| <b>Date of Transaction:</b> 09/03/2014   |  |
| CUSTOMER:  |  |
| DONALD BREMER<br>1325 N DELAWARE DR LOT 134<br>APACHE JUNCTION, AZ 85120-2567 US |  |

| LINE #        | QTY  | DESCRIPTION   | REMARKS                   | UNIT PRICE | TOTAL           |
|---------------|------|---|---------------------------|------------|-----------------|
| 1             | 1.00 | LOCATABLE MINERALS / MINING CLAIMS-NEW, UNADJUD, ONE OR MORE AUTH NOS / NEW MINING CLAIMS LOCATION FEE<br><b>CASES:</b> AMC429020/\$37.00     |                           | - n/a -    | 37.00           |
| 2             | 1.00 | LOCATABLE MINERALS / MINING CLAIMS-NEW, UNADJUD, ONE OR MORE AUTH NOS / NEW MINING CLAIMS MAINTENANCE FEE<br><b>CASES:</b> AMC429020/\$155.00 |                           | - n/a -    | 155.00          |
| 3             | 1.00 | LOCATABLE MINERALS / MINING CLAIMS-NEW, UNADJUD, ONE OR MORE AUTH NOS / NEW MINING CLAIM PROCESSING FEE<br><b>CASES:</b> AMC429020/\$20.00    |                           | - n/a -    | 20.00           |
| 4             | 1.00 | LOCATABLE MINERALS / MINING CLAIMS-NOT NEW-UNADJUD, ONE AUTH NO. ONLY / MINING CLAIM MONEY RECEIVED<br><b>CASES:</b> AMC429020/\$155.00       | NEW ASSOC PLACER LOCATION | - n/a -    | 155.00          |
| <b>TOTAL:</b> |      |   |                           |            | <b>\$367.00</b> |

| PAYMENT INFORMATION |         |  |             |            |
|---------------------|---------|--|-------------|------------|
| 1                   | AMOUNT: | 367.00   | POSTMARKED: | N/A        |
|                     | TYPE:   | CASH   | RECEIVED:   | 09/03/2014 |
|                     | NAME:   | BREMER, DONALD<br>1325 N DELAWARE DR LOT 134<br>APACHE JUNCTION AZ 85120-2567 US |             |            |

|         |
|---------|
| REMARKS |
|         |

This receipt was generated by the automated BLM Collections and Billing System and is a paper representation of a portion of the official electronic record contained therein.

**NOTICE!!**

**These documents have been scanned!**

**Do not place un-scanned documents beneath this notice!**

**Do not remove this notice from this file!**

GPO Jacket No. 560-102  
Print Order 61540  
Rise Business Services, LLC  
Job=AZ15 5/10/2019



Box Number= AZ15032



Claim Begin-End: AMC429020-AMC429020

2 Correspondence



AZ15032-9

AMC428906-AMC429539

U.S. Postal Service™

# CERTIFIED MAIL™ RECEIPT

*(Domestic Mail Only; No Insurance Coverage Provided)*

For delivery information visit our website at [www.usps.com](http://www.usps.com)®

## OFFICIAL USE

Postage

\$ 1.00 PHOENIX OFFICE

Certified Fee

0.00

Return Receipt Fee  
(Endorsement Required)

2015 MAY 13 P 2:34 Postmark Here

Restricted Delivery Fee  
(Endorsement Required)

PHOENIX, ARIZONA

T  
GARY PRICE

1325 N DELAWARE DR LOT 132  
APACHE JUNCTION AZ 85120-2567  
9310/RM/AMC429020

Se  
Sti  
or  
Cit

PS See Reverse for Instructions

7014 0150 0000 5453 6797

## Certified Mail Provides:

- A mailing receipt
- A unique identifier for your mailpiece
- A record of delivery kept by the Postal Service for two years

### ***Important Reminders:***

- Certified Mail may **ONLY** be combined with First-Class Mail® or Priority Mail®.
- Certified Mail is *not* available for any class of international mail.
- **NO INSURANCE COVERAGE IS PROVIDED** with Certified Mail. For valuables, please consider Insured or Registered Mail.
- For an additional fee, a *Return Receipt* may be requested to provide proof of delivery. To obtain Return Receipt service, please complete and attach a Return Receipt (PS Form 3811) to the article and add applicable postage to cover the fee. Endorse mailpiece "Return Receipt Requested". To receive a fee waiver for a duplicate return receipt, a USPS® postmark on your Certified Mail receipt is required.
- For an additional fee, delivery may be restricted to the addressee or addressee's authorized agent. Advise the clerk or mark the mailpiece with the endorsement "*Restricted Delivery*".
- If a postmark on the Certified Mail receipt is desired, please present the article at the post office for postmarking. If a postmark on the Certified Mail receipt is not needed, detach and affix label with postage and mail.

**IMPORTANT: Save this receipt and present it when making an inquiry.**

PS Form 3800, August 2006 (Reverse) PSN 7530-02-000-9047



**SENDER: COMPLETE THIS SECTION**

- Complete items 1, 2, and 3. Also complete item 4 if Restricted Delivery is desired.
- Print your name and address on the reverse so that we can return the card to you.
- Attach this card to the back of the mailpiece, or on the front if space permits.

1. Article Addressed to:

GARY PRICE  
 1325 N DELAWARE DR LOT 132  
 APACHE JUNCTION AZ 85120-2567  
 9310/RM/AMC429020

2. Article Number

(Transfer from service label)

7014 0150 0000 5453 6797

**COMPLETE THIS SECTION ON DELIVERY**

A. Signature

X

 Agent Addressee

B. Received by (Printed Name)

GARY PRICE

C. Date of Delivery

5-16-2015

D. Is delivery address different from item 1?  YesIf YES, enter delivery address below:  No

2015 MAY 19 P 2:51

PHOENIX, ARIZONA

3. Service Type

 Certified Mail® Priority Mail Express™ Registered Return Receipt for Merchandise Insured Mail Collect on Delivery

4. Restricted Delivery? (Extra Fee)

 Yes

UNITED STATES POSTAL SERVICE

AZ 852

16 MAY '15

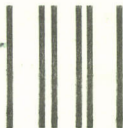

First-Class Mail  
Postage & Fees Paid  
USPS  
Permit No. G-10

PM 5 L

- Sender: Please print your name, address, and ZIP+4® in this box•

U.S. DEPARTMENT OF THE INTERIOR  
BUREAU OF LAND MANAGEMENT  
ARIZONA STATE OFFICE  
ONE NORTH CENTRAL AVENUE, SUITE 800  
PHOENIX, AZ 85004-4427





# United States Department of the Interior

BUREAU OF LAND MANAGEMENT

Arizona State Office

One North Central Avenue, Suite 800

Phoenix, Arizona 85004-4427

[www.blm.gov/az/](http://www.blm.gov/az/)



**MAY 13 2015**

In Reply Refer To:

3800 (9310) RM

**AMC429020**

CERTIFIED MAIL - RETURN RECEIPT REQUESTED No. 7014 0150 0000 5453 6797

## NOTICE

|                                |   |                                |
|--------------------------------|---|--------------------------------|
| GARY PRICE                     | : | This Notice Affects the Claims |
| 1325 N DELAWARE DR LOT 132     | : | Shown in the Block Below.      |
| APACHE JUNCTION, AZ 85120-2567 | : |                                |

---

AMC429020  
GOLDTIMERS

---

### Mining Claim Location Notice(s) – Amendment(s) Required

Pursuant to Title 43 Code of Federal Regulations (CFR) 3832.1, the Bureau of Land Management (BLM), Arizona State Office, received your notices of location for recording mining claims. In accordance with 43 CFR 3832.12, the claims listed above cannot be accepted as filed and must be amended as noted below.

The claim is an excess length. A placer claim with two owners cannot exceed 1320 feet in length. Your claim is 2640 feet in length. You must reduce the length of your claim from 2640 feet to 1320 feet. You may not take in new ground through an amendment.

When amending a claim, you cannot take in any new ground. Amending the claim may result in a claim that contains significantly less acreage than was originally located. If you wish to retain the same acreage, you may want to relocate the claim(s) correctly, rather than amend the incorrectly located claim(s).

You must file an amendment for each claim listed above to correct the defects identified. There is a \$10 BLM processing fee for each amendment. We must receive the amendments within 30 days of your receipt of this notice. If the amendments are not received within the 30 day timeframe the mining claims will be declared null and void.

If additional information is required, please contact RéAnn Myers at 602-417-9413. Please include your AMC serial number(s) on all correspondence.

Sincerely,

*Michael J Werner*  
for

Rebecca Heick  
Acting Deputy State Director  
Lands & Minerals Division

Enclosure(s)

---

U.S. Postal Service™

# CERTIFIED MAIL™ RECEIPT

*(Domestic Mail Only; No Insurance Coverage Provided)*

For delivery information visit our website at [www.usps.com](http://www.usps.com)®

# OFFICIAL USE

Postage

APACHE JUNCTION OFFICE

Certified Fee

2015 MAY 13 P 2:34

Postmark  
Here

Return Receipt Fee  
(Endorsement Required)

Restricted Delivery Fee  
(Endorsement Required)

PHOENIX, ARIZONA

Total Postage & Fees

DONALD BREMER

1325 N DELAWARE DR LOT 134

APACHE JUNCTION AZ 85120-2567

9310/RM/AMC429020

Sent 7

Street  
or PO

City, S

PS Fo

Instructions

7014 0150 0000 5455 6780

## Certified Mail Provides:

- A mailing receipt
- A unique identifier for your mailpiece
- A record of delivery kept by the Postal Service for two years

### ***Important Reminders:***

- Certified Mail may **ONLY** be combined with First-Class Mail® or Priority Mail®.
- Certified Mail is *not* available for any class of international mail.
- **NO INSURANCE COVERAGE IS PROVIDED** with Certified Mail. For valuables, please consider Insured or Registered Mail.
- For an additional fee, a *Return Receipt* may be requested to provide proof of delivery. To obtain Return Receipt service, please complete and attach a Return Receipt (PS Form 3811) to the article and add applicable postage to cover the fee. Endorse mailpiece "Return Receipt Requested". To receive a fee waiver for a duplicate return receipt, a USPS® postmark on your Certified Mail receipt is required.
- For an additional fee, delivery may be restricted to the addressee or addressee's authorized agent. Advise the clerk or mark the mailpiece with the endorsement "*Restricted Delivery*".
- If a postmark on the Certified Mail receipt is desired, please present the article at the post office for postmarking. If a postmark on the Certified Mail receipt is not needed, detach and affix label with postage and mail.

**IMPORTANT: Save this receipt and present it when making an inquiry.**

PS Form 3800, August 2006 (*Reverse*) PSN 7530-02-000-9047

**SENDER: COMPLETE THIS SECTION**

- Complete items 1, 2, and 3. Also complete item 4 if Restricted Delivery is desired.
- Print your name and address on the reverse so that we can return the card to you.
- Attach this card to the back of the mailpiece, or on the front if space permits.

1. Article Addressed to:

DONALD BREMER  
 1325 N DELAWARE DR LOT 134  
 APACHE JUNCTION AZ 85120-2567  
 9310/RM/AMC429020

2. Article Number

(Transfer from service label)

7014 0150 0000 5453 6780

**COMPLETE THIS SECTION ON DELIVERY**

A. Signature

X *Janice Bremer*  Agent  
 Addressee

B. Received by (Printed Name)

Janice Bremer

C. Date of Delivery

5-16-15

D. Is delivery address different from item 1?  YesIf YES, enter delivery address below:  No

2015 MAY 19 P 2:57

PHOENIX, ARIZONA

3. Service Type

- Certified Mail®  Priority Mail Express™  
 Registered  Return Receipt for Merchandise  
 Insured Mail  Collect on Delivery

4. Restricted Delivery? (Extra Fee)

 Yes

UNITED STATES POSTAL SERVICE

AZ 852

16 MAY '15

PM 5 L

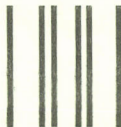

First-Class Mail  
Postage & Fees Paid  
USPS  
Permit No. G-10

- Sender: Please print your name, address, and ZIP+4<sup>®</sup> in this box•

U.S. DEPARTMENT OF THE INTERIOR  
BUREAU OF LAND MANAGEMENT  
ARIZONA STATE OFFICE  
ONE NORTH CENTRAL AVENUE, SUITE 800  
PHOENIX, AZ 85004-4427

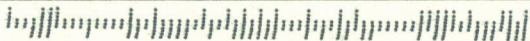





# United States Department of the Interior

BUREAU OF LAND MANAGEMENT

Arizona State Office

One North Central Avenue, Suite 800

Phoenix, Arizona 85004-4427

[www.blm.gov/az/](http://www.blm.gov/az/)



**MAY 13 2015**

In Reply Refer To:

3800 (9310) RM

**AMC429020**

CERTIFIED MAIL - RETURN RECEIPT REQUESTED No. 7014 0150 0000 5453 6780

## NOTICE

DONALD BREMER :  
1325 N DELAWARE DR LOT 134 :  
APACHE JUNCTION, AZ 85120-2567 :

This Notice Affects the Claims  
Shown in the Block Below.

---

AMC429020  
GOLDTIMERS

---

### Mining Claim Location Notice(s) – Amendment(s) Required

Pursuant to Title 43 Code of Federal Regulations (CFR) 3832.1, the Bureau of Land Management (BLM), Arizona State Office, received your notices of location for recording mining claims. In accordance with 43 CFR 3832.12, the claims listed above cannot be accepted as filed and must be amended as noted below.

The claim is an excess length. A placer claim with two owners cannot exceed 1320 feet in length. Your claim is 2640 feet in length. You must reduce the length of your claim from 2640 feet to 1320 feet. You may not take in new ground through an amendment.

When amending a claim, you cannot take in any new ground. Amending the claim may result in a claim that contains significantly less acreage than was originally located. If you wish to retain the same acreage, you may want to relocate the claim(s) correctly, rather than amend the incorrectly located claim(s).

You must file an amendment for each claim listed above to correct the defects identified. There is a \$10 BLM processing fee for each amendment. We must receive the amendments within 30 days of your receipt of this notice. If the amendments are not received within the 30 day timeframe the mining claims will be declared null and void.

If additional information is required, please contact RéAnn Myers at 602-417-9413. Please include your AMC serial number(s) on all correspondence.

Sincerely,

*Michael J Werner*  
for

Rebecca Heick  
Acting Deputy State Director  
Lands & Minerals Division

Enclosure(s)

---

**NOTICE!!**

**These documents have been scanned!**

**Do not place un-scanned documents beneath this notice!**

**Do not remove this notice from this file!**

GPO Jacket No. 560-102  
Print Order 61540  
Rise Business Services, LLC  
Job=AZ15 5/10/2019



Box Number= AZ15032



Claim Begin-End: AMC429020-AMC429020

3 Transfers



AZ15032-9

AMC428906-AMC429539

**NO  
DOCUMENTS  
FOUND**

NO DOCUMENTS FOUND  
NO DOCUMENTS FOUND

**NOTICE!!**

**These documents have been scanned!**

**Do not place un-scanned documents beneath this notice!**

**Do not remove this notice from this file!**

GPO Jacket No. 560-102  
Print Order 61540  
Rise Business Services, LLC  
Job=AZ15 5/10/2019



Box Number= AZ15032



Claim Begin-End: AMC429020-AMC429020

4 Annual Filings



AZ15032-9

AMC428906-AMC429539

UNITED STATES  
DEPARTMENT OF THE INTERIOR  
BUREAU OF LAND MANAGEMENT

MAINTENANCE FEE WAIVER CERTIFICATION

SEE INSTRUCTIONS ON PAGE 2

FORM APPROVED  
OMB NO. 1004-0114  
Expires: January 31, 2020

234

429020  
433685

428306  
429019

*[Handwritten signature]*

2018

- This small miner waiver is filed for the assessment year beginning on September 1, 2017 and ending on September 1, 2018 *2019* of America on September 1, 2017 *2018*
- The undersigned and all related parties owned ten or fewer mining claims, mill, or tunnel sites located and maintained on Federal lands in the United States
- The undersigned have performed the assessment work required by law for each mining claim listed prior to filing this waiver and understand that by filing this form, the undersigned must file an affidavit of assessment work with the Bureau of Land Management (BLM) by the December 30th following the filing of this waiver.
- The undersigned understand that if the assessment work obligation has not yet come due under 30 U.S.C. 28 (for those claims in their first assessment year only), a notice of intent to hold reciting this condition must be recorded by the December 30th following the filing of this waiver.
- The undersigned understand that mill and tunnel sites may also be listed on this waiver and be waived from payment of the maintenance fee, and that a notice of intent to hold for these sites is required to be filed with the BLM by the December 30th following the filing of this waiver.
- The undersigned understand and acknowledge that pursuant to 43 U.S.C. 1212 and 18 U.S.C. 1001, the filing or recording of a false, fictitious, or fraudulent document with the BLM may result in a fine of up to \$250,000, a prison term not to exceed five years, or both.
- The mining claims, mill or tunnel sites for which this waiver from payment of the maintenance fees is requested are:

| CLAIM OR SITE NAME | BLM RECORDATION SERIAL NUMBER |
|--------------------|-------------------------------|
| 1. Gold Timers     | 429020 (913)                  |
| 2. Gold Timers #2  | 433685                        |
| 3. Gold Timers #3  | 428306                        |
| 4. Gold Timers #4  | 429019                        |
| 5.                 |                               |
| 6.                 |                               |
| 7.                 |                               |
| 8.                 |                               |
| 9.                 |                               |
| 10.                |                               |

The owner(s) (claimants) of the above mining claims and sites are:

4th Donald F. Bremer  
 (Owner's Name - Please Print)  
 9421 E Main ST  
 (Owner's Mailing Address)

*Donald Bremer*  
 (Owner's Signature)  
 Mesa AZ 85207  
 (City) (State) (Zip Code)

3rd GARY PRICE  
 (Owner's Name - Please Print)  
 1363 N. PLAZA  
 (Owner's Mailing Address)

*Gary Price*  
 (Owner's Signature)  
 A.J. AZ 85120  
 (City) (State) (Zip Code)

(Owner's Name - Please Print)  
 (Owner's Mailing Address)

(Owner's Signature)  
 (City) (State) (Zip Code)

(Owner's Name - Please Print)  
 (Owner's Mailing Address)

(Owner's Signature)  
 (City) (State) (Zip Code)

AC 483  
 ENTERED SEP 12 2018

RECEIVED  
 PHOENIX, ARIZONA  
 2018 AUG 16 A 10:28  
 BLM AZ STATE OFFICE

rw/ps

|                               |                           |
|-------------------------------|---------------------------|
| (Owner's Name - Please Print) | (Owner's Signature)       |
| (Owner's Mailing Address)     | (City) (State) (Zip Code) |
|                               |                           |
| (Owner's Name - Please Print) | (Owner's Signature)       |
| (Owner's Mailing Address)     | (City) (State) (Zip Code) |
|                               |                           |
| (Owner's Name - Please Print) | (Owner's Signature)       |
| (Owner's Mailing Address)     | (City) (State) (Zip Code) |
|                               |                           |
| (Owner's Name - Please Print) | (Owner's Signature)       |
| (Owner's Mailing Address)     | (City) (State) (Zip Code) |

18 U.S.C. 1001 and 43 U.S.C. 1212 make it a crime for any person knowingly and willfully to make to any department or agency of the United States any false, fictitious or fraudulent statements or representations as to any matter within its jurisdiction.

**INSTRUCTIONS**

1. This certification is made under the provisions of 43 U.S.C. § 1744 and 30 U.S.C. §28-28k and the regulations thereunder (43 CFR Part 3830).
2. The claimant(s) must fill in the dates in paragraph 1 for the beginning and ending of the assessment year for which this waiver is sought.
3. The claimant(s) must fill in the date in paragraph 2 for the beginning of the assessment year for which this waiver is sought.
4. All claim and site names and BLM serial numbers must be listed for the mining claims, mill sites, and tunnel sites for which the waiver is sought.
5. All owners of the mining claims, mill sites, and tunnel sites and their addresses must be given.
6. This waiver form must be signed by all the claimants or their designated agent, in original form. If an agent is designated, a notarized designation of agent, signed by all of the claimants with proper address given, must be submitted with this waiver.
7. This form must be filed no later than September 1st for the upcoming assessment year in the BLM State Office where the mining claims or sites are recorded, or the waiver cannot be granted by the BLM. (Example: To obtain a waiver for the assessment year 2012, which begins on September 1, 2011, you must qualify for and file for a waiver no later than September 1, 2011, in the proper BLM State Office.)
8. For all mining claims which require assessment work, you must record an affidavit of labor on or before the December 30th immediately following the filing of this waiver. For all other mining claims or sites waived, you must record a notice of intent to hold on or before the December 30th immediately following the filing of this waiver.
9. Mill and tunnel sites may also be listed on this waiver and be waived from payment of the maintenance fee. A notice of intent to hold for these sites is required to be filed by the December 30th following the filing of this waiver.

PHOENIX, ARIZONA  
 2010 AUG 16 A 10: 28  
 RECEIVED  
 BLM AZ STATE OFFICE

FOR OFFICIAL USE ONLY

UNITED STATES  
DEPARTMENT OF THE INTERIOR  
BUREAU OF LAND MANAGEMENT

MAINTENANCE FEE WAIVER CERTIFICATION

SEE INSTRUCTIONS ON PAGE 2

FORM APPROVED  
OMB NO. 1004-0114  
Expires: January 31, 2020

Attach to  
234  
*[Signature]*

429020

433685

428306

429019

- This small miner waiver is filed for the assessment year beginning on September 1, ~~2017~~<sup>2018</sup> and ending on September 1, ~~2018~~<sup>19</sup> of America on September 1, ~~2018~~<sup>19</sup>.
- The undersigned and all related parties own ten or fewer mining claims, mill, or tunnel sites located and maintained on Federal lands in the United States of America on September 1, ~~2018~~<sup>19</sup>.
- The undersigned have performed the assessment work required by law for each mining claim listed prior to filing this waiver and understand that by filing this form, the undersigned must file an affidavit of assessment work with the Bureau of Land Management (BLM) by the December 30th following the filing of this waiver.
- The undersigned understand that if the assessment work obligation has not yet come due under 30 U.S.C. 28 (for those claims in their first assessment year only), a notice of intent to hold reciting this condition must be recorded by the December 30th following the filing of this waiver.
- The undersigned understand that mill and tunnel sites may also be listed on this waiver and be waived from payment of the maintenance fee, and that a notice of intent to hold for these sites is required to be filed with the BLM by the December 30th following the filing of this waiver.
- The undersigned understand and acknowledge that pursuant to 43 U.S.C. 1212 and 18 U.S.C. 1001, the filing or recording of a false, fictitious, or fraudulent document with the BLM may result in a fine of up to \$250,000, a prison term not to exceed five years, or both.
- The mining claims, mill or tunnel sites for which this waiver from payment of the maintenance fees is requested are:

| CLAIM OR SITE NAME | BLM RECORDATION SERIAL NUMBER |
|--------------------|-------------------------------|
| 1. Gold timers     | AMC# 429020                   |
| 2. Gold timers #2  | AMC# 433685                   |
| 3. Gold timers #3  | AMC# 428306                   |
| 4. Gold timers #4  | AMC# 429019                   |
| 5.                 |                               |
| 6.                 |                               |
| 7.                 |                               |
| 8.                 |                               |
| 9.                 |                               |
| 10.                |                               |

RECEIVED  
BLM AZ STATE OFFICE  
2018 SEP -4 P 12:12  
PHOENIX, ARIZONA

The owner(s) (claimants) of the above mining claims and sites are:

Donald F. Bremer

(Owner's Name - Please Print)

9421 E Main St. B47

(Owner's Mailing Address)

*Donald F. Bremer*

(Owner's Signature)

Mesa

(City)

AZ 85207

(State)

(Zip Code)

GARY PRICE

(Owner's Name - Please Print)

1363 N. PLAZA LOT 8

(Owner's Mailing Address)

*Gary Price*

(Owner's Signature)

AJ

(City)

AZ 85120

(State)

(Zip Code)

(Owner's Name - Please Print)

(Owner's Signature)

(Owner's Mailing Address)

(City)

(State)

(Zip Code)

(Owner's Name - Please Print)

(Owner's Signature)

(Owner's Mailing Address)

(City)

(State)

(Zip Code)

(Continued on page 2)

THIS IS AN EXTRA WVR FOR 2019.  
I PROCESSED THE ONE WE REC'D ON 8-16-18.

RS



|                               |                     |         |            |
|-------------------------------|---------------------|---------|------------|
| (Owner's Name - Please Print) | (Owner's Signature) |         |            |
| (Owner's Mailing Address)     | (City)              | (State) | (Zip Code) |
| -----                         |                     |         |            |
| (Owner's Name - Please Print) | (Owner's Signature) |         |            |
| (Owner's Mailing Address)     | (City)              | (State) | (Zip Code) |
| -----                         |                     |         |            |
| (Owner's Name - Please Print) | (Owner's Signature) |         |            |
| (Owner's Mailing Address)     | (City)              | (State) | (Zip Code) |
| -----                         |                     |         |            |
| (Owner's Name - Please Print) | (Owner's Signature) |         |            |
| (Owner's Mailing Address)     | (City)              | (State) | (Zip Code) |

18 U.S.C. 1001 and 43 U.S.C. 1212 make it a crime for any person knowingly and willfully to make to any department or agency of the United States any false, fictitious or fraudulent statements or representations as to any matter within its jurisdiction.

INSTRUCTIONS

1. This certification is made under the provisions of 43 U.S.C. § 1744 and 30 U.S.C. §28-28k and the regulations thereunder (43 CFR Part 3830)
2. The claimant(s) must fill in the dates in paragraph 1 for the beginning and ending of the assessment year for which this waiver is sought.
3. The claimant(s) must fill in the date in paragraph 2 for the beginning of the assessment year for which this waiver is sought.
4. All claim and site names and BLM serial numbers must be listed for the mining claims, mill sites, and tunnel sites for which the waiver is sought.
5. All owners of the mining claims, mill sites, and tunnel sites and their addresses must be given.
6. This waiver form must be signed by all the claimants or their designated agent, in original form. If an agent is designated, a notarized designation of agent, signed by all of the claimants with proper address given, must be submitted with this waiver.
7. This form must be filed no later than September 1st for the upcoming assessment year in the BLM State Office where the mining claims or sites are recorded, or the waiver cannot be granted by the BLM. (Example: To obtain a waiver for the assessment year 2012, which begins on September 1, 2011, you must qualify for and file for a waiver no later than September 1, 2011, in the proper BLM State Office.)
8. For all mining claims which require assessment work, you must record an affidavit of labor on or before the December 30th immediately following the filing of this waiver. For all other mining claims or sites waived, you must record a notice of intent to hold on or before the December 30th immediately following the filing of this waiver.
9. Mill and tunnel sites may also be listed on this waiver and be waived from payment of the maintenance fee. A notice of intent to hold for these sites is required to be filed by the December 30th following the filing of this waiver.

FOR OFFICIAL USE ONLY

Donald Bremer  
9421 E Main St. B47  
Mesa, AZ 85207

PHOENIX AZ 852

29 AUG 2018 PM 11 L



RECEIVED  
BLM AZ STATE OFFICE

2018 SEP -4 P 12:11

PHOENIX, ARIZONA

Bureau of Land Management  
One North Central Avenue Suite 800  
Phoenix, Arizona 85004-4427

85004-442700

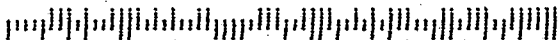

Ronald Bremer  
9421 E Main St B47  
Mesa, AZ 85207

PHOENIX, AZ 852

29 AUG 2018 PM 11 L

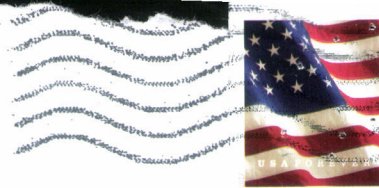

RECEIVED  
BLM AZ STATE OFFICE

2018 SEP -4 P 12:11

PHOENIX, ARIZONA

Bureau of Land Management  
One North Central Avenue Suite 800  
Phoenix, Arizona 85004-4427

85004-442700



DEPARTMENT OF THE INTERIOR  
BUREAU OF LAND MANAGEMENT  
MAINTENANCE FEE WAIVER CERTIFICATION

FORM APPROVED  
OMB NO. 1004-0114  
Expires: January 31, 2020

SEE INSTRUCTIONS ON PAGE 2

2018

1. This small miner waiver is filed for the assessment year beginning on September 1, 2017 and ending on September 1, 2018 2019
2. The undersigned and all related parties owned ten or fewer mining claims, mill, or tunnel sites located and maintained on Federal lands in the United States of America on September 1, 2017 2018
3. The undersigned have performed the assessment work required by law for each mining claim listed prior to filing this waiver and understand that by filing this form, the undersigned must file an affidavit of assessment work with the Bureau of Land Management (BLM) by the December 30th following the filing of this waiver.
4. The undersigned understand that if the assessment work obligation has not yet come due under 30 U.S.C. 28 (for those claims in their first assessment year only), a notice of intent to hold reciting this condition must be recorded by the December 30th following the filing of this waiver.
5. The undersigned understand that mill and tunnel sites may also be listed on this waiver and be waived from payment of the maintenance fee, and that a notice of intent to hold for these sites is required to be filed with the BLM by the December 30th following the filing of this waiver.
6. The undersigned understand and acknowledge that pursuant to 43 U.S.C. 1212 and 18 U.S.C. 1001, the filing or recording of a false, fictitious, or fraudulent document with the BLM may result in a fine of up to \$250,000, a prison term not to exceed five years, or both.
7. The mining claims, mill or tunnel sites for which this waiver from payment of the maintenance fees is requested are:

| CLAIM OR SITE NAME | BLM RECORDATION SERIAL NUMBER |
|--------------------|-------------------------------|
| 1. Gold Timers     | 429020                        |
| 2. Gold Timers #2  | 433685                        |
| 3. Gold Timers #3  | 428306                        |
| 4. Gold Timers #4  | 429019                        |
| 5.                 |                               |
| 6.                 |                               |
| 7.                 |                               |
| 8.                 |                               |
| 9.                 |                               |
| 10.                |                               |

RECEIVED  
BLM AZ STATE OFFICE  
2018 SEP -4 P 12:19  
PHOENIX, ARIZONA

The owner(s) (claimants) of the above mining claims and sites are:

Donald F. Bremer  
(Owner's Name - Please Print)  
9421 E Main ST B47  
(Owner's Mailing Address)

Donald Bremer  
(Owner's Signature)  
Mesa AZ 85207  
(City) (State) (Zip Code)

GARY PRICE  
(Owner's Name - Please Print)  
1363 N. PLAZA LOT 8  
(Owner's Mailing Address)

Gary Price  
(Owner's Signature)  
A. J. AZ 85120  
(City) (State) (Zip Code)

\_\_\_\_\_  
(Owner's Name - Please Print)  
\_\_\_\_\_  
(Owner's Mailing Address)

\_\_\_\_\_  
(Owner's Signature)  
\_\_\_\_\_  
(City) (State) (Zip Code)

\_\_\_\_\_  
(Owner's Name - Please Print)  
\_\_\_\_\_  
(Owner's Mailing Address)

\_\_\_\_\_  
(Owner's Signature)  
\_\_\_\_\_  
(City) (State) (Zip Code)

RECEIVED  
BLM AZ STATE OFFICE  
2018 AUG 16 A 10:28  
PHOENIX, ARIZONA

COPY

\_\_\_\_\_  
(Owner's Name - Please Print)

\_\_\_\_\_  
(Owner's Signature)

\_\_\_\_\_  
(Owner's Mailing Address)

\_\_\_\_\_  
(City) (State) (Zip Code)

\_\_\_\_\_  
(Owner's Name - Please Print)

\_\_\_\_\_  
(Owner's Signature)

\_\_\_\_\_  
(Owner's Mailing Address)

\_\_\_\_\_  
(City) (State) (Zip Code)

\_\_\_\_\_  
(Owner's Name - Please Print)

\_\_\_\_\_  
(Owner's Signature)

\_\_\_\_\_  
(Owner's Mailing Address)

\_\_\_\_\_  
(City) (State) (Zip Code)

\_\_\_\_\_  
(Owner's Name - Please Print)

\_\_\_\_\_  
(Owner's Signature)

\_\_\_\_\_  
(Owner's Mailing Address)

\_\_\_\_\_  
(City) (State) (Zip Code)

18 U.S.C. 1001 and 43 U.S.C. 1212 make it a crime for any person knowingly and willfully to make to any department or agency of the United States any false, fictitious or fraudulent statements or representations as to any matter within its jurisdiction.

**INSTRUCTIONS**

1. This certification is made under the provisions of 43 U.S.C. § 1744 and 30 U.S.C. §28-28k and the regulations thereunder (43 CFR Part 3830).
2. The claimant(s) must fill in the dates in paragraph 1 for the beginning and ending of the assessment year for which this waiver is sought.
3. The claimant(s) must fill in the date in paragraph 2 for the beginning of the assessment year for which this waiver is sought.
4. All claim and site names and BLM serial numbers must be listed for the mining claims, mill sites, and tunnel sites for which the waiver is sought.
5. All owners of the mining claims, mill sites, and tunnel sites and their addresses must be given.
6. This waiver form must be signed by all the claimants or their designated agent, in original form. If an agent is designated, a notarized designation of agent, signed by all of the claimants with proper address given, must be submitted with this waiver.
7. This form must be filed no later than September 1st for the upcoming assessment year in the BLM State Office where the mining claims or sites are recorded, or the waiver cannot be granted by the BLM. (Example: To obtain a waiver for the assessment year 2012, which begins on September 1, 2011, you must qualify for and file for a waiver no later than September 1, 2011, in the proper BLM State Office.)
8. For all mining claims which require assessment work, you must record an affidavit of labor on or before the December 30th immediately following the filing of this waiver. For all other mining claims or sites waived, you must record a notice of intent to hold on or before the December 30th immediately following the filing of this waiver.
9. Mill and tunnel sites may also be listed on this waiver and be waived from payment of the maintenance fee. A notice of intent to hold for these sites is required to be filed by the December 30th following the filing of this waiver.

PHOENIX, ARIZONA  
 2011 AUG 16 A 10 28  
 RECEIVED  
 BLM AZ STATE OFFICE

FOR OFFICIAL USE ONLY

When Recorded Return Document to:  
Donald Bremer  
9421 E Main St B-47  
Mesa, AZ 85207

AMC 428306  
 429019  
 429020  
 433685

Check here if this is a change of address.  
 Telephone: 660-890-5999  
 E-mail address: DFB1945@Yahoo.com

**AFFIDAVIT OF PERFORMANCE OF ANNUAL WORK**

1. State of Arizona, County of Yavapai ss:  
 2. I (Name) Donald Bremer  
 3. Reside at (Address) 9421 E Main St B-47  
 City Mesa County Maricopa

RECEIVED  
 PHOENIX, ARIZONA  
 2018 AUG 16 A 10:28  
 BLM  
 Date  
 Stamp

State AZ zip 85207 being duly sworn, depose and say that I am a citizen of the United States, more than eighteen years of age, and that all of the facts set forth in this affidavit, subject to the provisions and penalties of 18 U.S.C. 1001 pertaining to the filing of false, fictitious, or fraudulent statements with the United States, are true and correct according to the best of my knowledge, information and belief.  
 4. Owner's name and address (If not shown in Items 1-3 above), \_\_\_\_\_

5. That I am personally acquainted with the mining claim(s). The work and improvements were made by and at the expense of the owner(s) of said claim(s). Said contiguous group of claims, listed on this document, are situated in the \_\_\_\_\_ (optional) Mining District; \_\_\_\_\_ County, Arizona.

| Line No. | AMC NUMBER | CLAIM/SITE NAME | COUNTY RECORDER DATA (If available) | TWP | RNG | SEC |
|----------|------------|-----------------|-------------------------------------|-----|-----|-----|
| 1        | 429020     | Gold Timers     |                                     |     |     |     |
| 2        | 433685     | Gold Timers #2  |                                     |     |     |     |
| 3        | 428306     | Gold Timers #3  |                                     |     |     |     |
| 4        | 429019     | Gold Timers #4  |                                     |     |     |     |
| 5        |            |                 |                                     |     |     |     |
| 6        |            |                 |                                     |     |     |     |

ENTERED  
 AUG 24 2018  
 BY: RM

RECEIVED  
 PINAL AZ STATE OFFICE  
 PHOENIX, ARIZONA  
 2018 AUG 16 A 10:28  
 BLM  
 Date  
 Stamp

|    |  |  |  |  |  |
|----|--|--|--|--|--|
| 7  |  |  |  |  |  |
| 8  |  |  |  |  |  |
| 9  |  |  |  |  |  |
| 10 |  |  |  |  |  |

6. That between the dates starting at 12 o'clock noon on September 1, 20 17 and ending at 12 o'clock noon on September 1, 20 18 at least \$ 400.00 dollars worth of work and improvements were done and performed upon said claim(s) or upon one or more of a contiguous group of claims for the benefit of all, wholly or partly outside of a contiguous group of claims for the benefit of all, not including the location work.

7. That the following persons were employed to perform the work and improvements described herein: Gary Price, Fred Yates, Richard Nevers, George Bates

8. That the work and improvements performed were: Roadwork washed out, removed rocks, trimmed limbs @ \$20.00 per hr  
32 hours = \$640.00

9. Dated: 8-13-2018 Signature: Donald Bremer

SUBSCRIBED AND SWORN TO before me, a Notary Public, this 13<sup>th</sup> day of August 20 18

By: Donald Bremer

Notary Public [Signature]

My Commission Expires 7-19-19

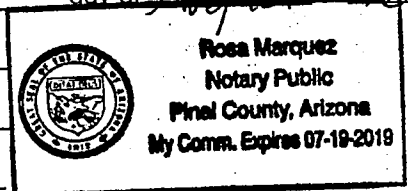

Bureau of Land Management  
 Arizona State Office  
[www.blm.gov/az](http://www.blm.gov/az)

No. of Claims: \_\_\_\_\_ x \$10 = \_\_\_\_\_  
 Check No.: \_\_\_\_\_ Init. \_\_\_\_\_  
 Receipt No.: 4236716  
 For BLM Use Only

**United States Department of the Interior**  
**Bureau of Land Management**  
 DIV OF LANDS, MINRLS & ENERGY  
 ONE N CENTRAL AVE  
 PHOENIX, AZ 85004 -4427  
 Phone: 602-417-9200

Receipt

No: 4236716

|   |  |
|---|--|
| <b>Transaction #:</b> 4352097                                     |  |
| <b>Date of Transaction:</b> 08/16/2018                            |  |
| <b>CUSTOMER:</b>  |  |
| DONALD BREMER<br>9421 E MAIN ST<br>#B47<br>MESA, AZ 85207-8822 US |  |

| LINE #        | QTY  | DESCRIPTION   | REMARKS        | UNIT PRICE | TOTAL          |
|---------------|------|---|----------------|------------|----------------|
| 1             | 1.00 | LOCATABLE MINERALS / MINING CLAIMS- NOT NEW-UNADJUD, ONE AUTH NO. ONLY / MINING CLAIM MONEY RECEIVED<br><b>CASES: AMC429020/\$40.00</b> | POL 2018/4 WAV | - n/a -    | 40.00          |
| <b>TOTAL:</b> |      |   |                |            | <b>\$40.00</b> |

| PAYMENT INFORMATION |         |   |                      |
|---------------------|---------|---|----------------------|
| 1                   | AMOUNT: | 40.00   | POSTMARKED: N/A      |
|                     | TYPE:   | CASH  | RECEIVED: 08/16/2018 |
|                     | NAME:   | BREMER, DONALD<br>9421 E MAIN ST<br>#B47<br>MESA AZ 85207-8822 US |                      |

|         |
|---------|
| REMARKS |
|         |

This receipt was generated by the automated BLM Collections and Billing System and is a paper representation of a portion of the official electronic record contained therein.



UNITED STATES  
DEPARTMENT OF THE INTERIOR  
BUREAU OF LAND MANAGEMENT

MAINTENANCE FEE WAIVER CERTIFICATION

AMC 429020  
433685  
429019  
FORM APPROVED  
OMB NO. 1004-0114  
Expires: January 31, 2020

SEE INSTRUCTIONS ON PAGE 2

- This small miner waiver is filed for the assessment year beginning on September 1, 2017 and ending on September 1, 2018.
- The undersigned and all related parties owned ten or fewer mining claims, mill, or tunnel sites located and maintained on Federal lands in the United States of America on September 1, 2017.
- The undersigned have performed the assessment work required by law for each mining claim listed prior to filing this waiver and understand that by filing this form, the undersigned must file an affidavit of assessment work with the Bureau of Land Management (BLM) by the December 30th following the filing of this waiver.
- The undersigned understand that if the assessment work obligation has not yet come due under 30 U.S.C. 28 (for those claims in their first assessment year only), a notice of intent to hold reciting this condition must be recorded by the December 30th following the filing of this waiver.
- The undersigned understand that mill and tunnel sites may also be listed on this waiver and be waived from payment of the maintenance fee, and that a notice of intent to hold for these sites is required to be filed with the BLM by the December 30th following the filing of this waiver.
- The undersigned understand and acknowledge that pursuant to 43 U.S.C. 1212 and 18 U.S.C. 1001, the filing or recording of a false, fictitious, or fraudulent document with the BLM may result in a fine of up to \$250,000, a prison term not to exceed five years, or both.
- The mining claims, mill or tunnel sites for which this waiver from payment of the maintenance fees is requested are:

| CLAIM OR SITE NAME | BLM RECORDATION SERIAL NUMBER |
|--------------------|-------------------------------|
| 1. Goldtimers      | 429020                        |
| 2. Goldtimers #2   | 433685                        |
| 3. Goldtimers #3   | 428306                        |
| 4. Goldtimers #4   | 429019                        |
| 5.                 |                               |
| 6.                 |                               |
| 7.                 |                               |
| 8.                 |                               |
| 9.                 |                               |
| 10.                |                               |

The owner(s) (claimants) of the above mining claims and sites are:

Donald F. Bremer (Owner's Name - Please Print)      Donald Bremer (Owner's Signature)  
9421 E. Main ST site B47 Mesa AZ 85207  
 (Owner's Mailing Address)      (City)      (State)      (Zip Code)

GARY PRICE (Owner's Name - Please Print)      [Signature] (Owner's Signature)  
1363 N. PLAZA LOT-8 (Owner's Mailing Address)      AJ (City)      AZ 85210 (State)      (Zip Code)

\_\_\_\_\_  
 (Owner's Name - Please Print)      (Owner's Signature)  
 \_\_\_\_\_  
 (Owner's Mailing Address)      PHOENIX, ARIZONA (City)      (State)      (Zip Code)

\_\_\_\_\_  
 (Owner's Name - Please Print)      (Owner's Signature)  
 \_\_\_\_\_  
 (Owner's Mailing Address)      RECEIVED (City)      (State)      (Zip Code)

483  
 RECEIVED  
 SEP 07 2017  
 BY: [Signature]

(Continued on page 2)

[Handwritten initials]

|                               |                     |         |            |
|-------------------------------|---------------------|---------|------------|
| (Owner's Name - Please Print) | (Owner's Signature) |         |            |
| (Owner's Mailing Address)     | (City)              | (State) | (Zip Code) |
|                               |                     |         |            |
| (Owner's Name - Please Print) | (Owner's Signature) |         |            |
| (Owner's Mailing Address)     | (City)              | (State) | (Zip Code) |
|                               |                     |         |            |
| (Owner's Name - Please Print) | (Owner's Signature) |         |            |
| (Owner's Mailing Address)     | (City)              | (State) | (Zip Code) |
|                               |                     |         |            |
| (Owner's Name - Please Print) | (Owner's Signature) |         |            |
| (Owner's Mailing Address)     | (City)              | (State) | (Zip Code) |

18 U.S.C. 1001 and 43 U.S.C. 1212 make it a crime for any person knowingly and willfully to make to any department or agency of the United States any false, fictitious or fraudulent statements or representations as to any matter within its jurisdiction.

**INSTRUCTIONS**

1. This certification is made under the provisions of 43 U.S.C. § 1744 and 30 U.S.C. §28-28k and the regulations thereunder (43 CFR Part 3830).
2. The claimant(s) must fill in the dates in paragraph 1 for the beginning and ending of the assessment year for which this waiver is sought.
3. The claimant(s) must fill in the date in paragraph 2 for the beginning of the assessment year for which this waiver is sought.
4. All claim and site names and BLM serial numbers must be listed for the mining claims, mill sites, and tunnel sites for which the waiver is sought.
5. All owners of the mining claims, mill sites, and tunnel sites and their addresses must be given.
6. This waiver form must be signed by all the claimants or their designated agent, in original form. If an agent is designated, a notarized designation of agent, signed by all of the claimants with proper address given, must be submitted with this waiver.
7. This form must be filed no later than September 1st for the upcoming assessment year in the BLM State Office where the mining claims or sites are recorded, or the waiver cannot be granted by the BLM. (Example: To obtain a waiver for the assessment year 2012, which begins on September 1, 2011, you must qualify for and file for a waiver no later than September 1, 2011, in the proper BLM State Office.)
8. For all mining claims which require assessment work, you must record an affidavit of labor on or before the December 30th immediately following the filing of this waiver. For all other mining claims or sites waived, you must record a notice of intent to hold on or before the December 30th immediately following the filing of this waiver.
9. Mill and tunnel sites may also be listed on this waiver and be waived from payment of the maintenance fee. A notice of intent to hold for these sites is required to be filed by the December 30th following the filing of this waiver.

RECEIVED

M AZ STATE OFFICE

2017 AUG 28 A 9:51

PHOENIX ARIZONA

FOR OFFICIAL USE ONLY

When Recorded Return Document is to:

Donald Bremer  
9421 E. Main St. - B47  
Mesa, AZ 85207

429020  
433685  
428306  
429019

Check here if this is a change of address

Telephone: 660-890-5999

E-mail address: DFB1945@yahoo.com

**AFFIDAVIT OF PERFORMANCE OF ANNUAL WORK**

- 1. State of Arizona, County of Yavapai ss:
- 2. I (Name) Donald Bremer
- 3. Reside at (Address) 9421 E. Main St - B47

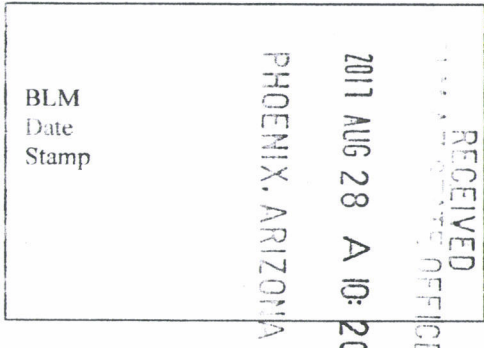

City Mesa County Maricopa

State AZ Zip 85207 being duly sworn, depose and say that I am a citizen of the United States, more than eighteen years of age, and that all of the facts set forth in this affidavit, subject to the provisions and penalties of 18 U.S.C. 1001 pertaining to the filing of false, fictitious, or fraudulent statements with the United States, are true and correct according to the best of my knowledge, information, and belief.

4. Owner's name and address (if not shown in Items 1-3 above): \_\_\_\_\_

5. That I am personally acquainted with the mining claim(s). The work and improvements were made by and at the expense of the owner(s) or each of them. Said contiguous group of claims, listed on this instrument, are situated in the

\_\_\_\_\_ (optional) Mining District; \_\_\_\_\_ County, Arizona.

| Line No. | AMC NUMBER | CLAIM/SITE NAME | COUNTY RECORDER DATA (If available) | TWP | RNG | SEC |
|----------|------------|-----------------|-------------------------------------|-----|-----|-----|
| 1        | 429020     | Gold timers     |                                     |     |     |     |
| 2        | 433685     | Gold timers #2  |                                     |     |     |     |
| 3        | 428306     | Gold timers #3  |                                     |     |     |     |
| 4        | 429019     | Gold timers #4  |                                     |     |     |     |
| 5        |            |                 |                                     |     |     |     |
| 6        |            |                 |                                     |     |     |     |

Donald F. Bremer

Form: MCF108  
Revised July 2014



BLM  
Date  
Stamp

PHOENIX, ARIZONA  
2011 AUG 28 A 10:20

RECEIVED  
STATE OFFICE

|    |  |  |  |  |  |
|----|--|--|--|--|--|
| 7  |  |  |  |  |  |
| 8  |  |  |  |  |  |
| 9  |  |  |  |  |  |
| 10 |  |  |  |  |  |

6. That between the dates starting at 12 o'clock noon on September 1, 20 16 and ending at 12 o'clock noon on September 1, 20 17 at least \$ 400.00 dollars worth of work and improvements were done and performed upon said claim(s) or upon one or more of a contiguous group of claims for the benefit of all, wholly or partly outside of a contiguous group of claims for the benefit of all, not including the location work.

7. That the following persons were employed to perform the work and improvements described herein: Donald Bremer, Gary Price, & Fred Yates

8. That the work and improvements performed were Road work - washed out, removed some rocks - trimmed limbs @ \$20.00 per hour 32 hours = \$640.00

9. Dated: 8-28-2017 Signature: Donald Bremer

SUBSCRIBED AND SWORN TO before me a Notary Public this 28 day of August 20 17

By: Donald F Bremer

Notary Public [Signature]  
My Commission Expires 3/27/2020

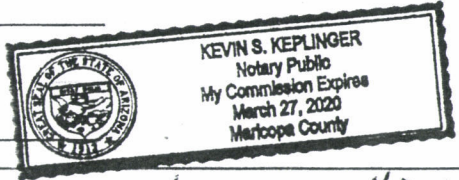

Bureau of Land Management  
Arizona State Office

No. of Claims: 4 x \$10 = 40.00  
 Check No.: Cash Init. EB  
 Receipt No.: 3962646  
 For BLM Use Only

Form: MCF108  
Revised July 2014

**United States Department of the Interior**  
**Bureau of Land Management**  
 DIV OF LANDS, MINRLS & ENERGY  
 ONE N CENTRAL AVE  
 PHOENIX, AZ 85004 -4427  
 Phone: 602-417-9200

Receipt

No: 3962646

|  |  |
|--|--|
| <b>Transaction #:</b> 4072491                                    |  |
| <b>Date of Transaction:</b> 08/28/2017                           |  |
| <b>CUSTOMER:</b>   |  |
| DONALD BREMER<br>9421 E MAIN ST<br>#B47<br>MESA,AZ 85207-8822 US |  |

| LINE #        | QTY  | DESCRIPTION  | REMARKS                  | UNIT PRICE | TOTAL          |
|---------------|------|--|--------------------------|------------|----------------|
| 1             | 1.00 | LOCATABLE MINERALS / MINING CLAIMS- NOT NEW-UNADJUD,ONE AUTH NO. ONLY / MINING CLAIM MONEY RECEIVED<br><b>CASES: AMC429020/\$40.00</b> | 2017 POL & 2018 WAIV (4) | - n/a -    | 40.00          |
| <b>TOTAL:</b> |      |  |                          |            | <b>\$40.00</b> |

| PAYMENT INFORMATION |         |   |             |            |  |
|---------------------|---------|---|-------------|------------|--|
| 1                   | AMOUNT: | 40.00   | POSTMARKED: | N/A        |  |
|                     | TYPE:   | CASH  | RECEIVED:   | 08/28/2017 |  |
|                     | NAME:   | BREMER, DONALD<br>9421 E MAIN ST<br>#B47<br>MESA AZ 85207-8822 US |             |            |  |

|         |
|---------|
| REMARKS |
|         |

This receipt was generated by the automated BLM Collections and Billing System and is a paper representation of a portion of the official electronic record contained therein.

327

PER 428306 429020  
429019 433685

FORM APPROVED  
OMB NO. 1004-0114  
Expires: October 31, 2016

MAINTENANCE FEE WAIVER CERTIFICATION

SEE INSTRUCTIONS ON PAGE 2

1. This small miner waiver is filed for the assessment year beginning on September 1, 2016 and ending on September 1, 2017.
2. The undersigned and all related parties owned ten or fewer mining claims, mill, or tunnel sites located and maintained on Federal lands in the United States of America on September 1, 2016.
3. The undersigned have performed the assessment work required by law for each mining claim listed prior to filing this waiver and understand that by filing this form, the undersigned must file an affidavit of assessment work with the Bureau of Land Management (BLM) by the December 30th following the filing of this waiver.
4. The undersigned understand that if the assessment work obligation has not yet come due under 30 U.S.C. 28 (for those claims in their first assessment year only), a notice of intent to hold reciting this condition must be recorded by the December 30th following the filing of this waiver.
5. The undersigned understand that mill and tunnel sites may also be listed on this waiver and be waived from payment of the maintenance fee, and that a notice of intent to hold for these sites is required to be filed with the BLM by the December 30th following the filing of this waiver.
6. The undersigned understand and acknowledge that pursuant to 43 U.S.C. 1212 and 18 U.S.C. 1001, the filing or recording of a false, fictitious, or fraudulent document with the BLM may result in a fine of up to \$250,000, a prison term not to exceed five years, or both.
7. The mining claims, mill or tunnel sites for which this waiver from payment of the maintenance fees is requested are:

| CLAIM OR SITE NAME | BLM RECORDATION SERIAL NUMBER |
|--------------------|-------------------------------|
| 1. Gold timers     | AMC-429020 ✓                  |
| 2. Gold timers #2  | AMC-433685                    |
| 3. Gold timers #3  | AMC-428306                    |
| 4. Gold timers #4  | AMC-429019                    |
| 5.                 |                               |
| 6.                 |                               |
| 7.                 |                               |
| 8.                 |                               |
| 9.                 |                               |
| 10.                |                               |

The owner(s) (claimants) of the above mining claims and sites are:

4 NW  
4 Ronald F. Bremner  
(Owner's Name - Please Print)  
9421 E Main St # B47  
(Owner's Mailing Address)

Donald Bremner  
(Owner's Signature)  
Mesa AZ 85207  
(City) (State) (Zip Code)

3 GARY PRICE  
(Owner's Name - Please Print)  
1363 NORTH PLAZA  
(Owner's Mailing Address)

Gary Price  
(Owner's Signature)  
APACHE JUNIOR AZ. 85120  
(City) (State) (Zip Code)

ENTERED SEP 08 2016  
AC 170 (D BREMER + G PRICE)  
PB

(Owner's Name - Please Print)  
(Owner's Mailing Address)

(Owner's Signature)  
(City) (State) (Zip Code)

(Owner's Name - Please Print)  
(Owner's Mailing Address)

(Owner's Signature)  
(City) (State) (Zip Code)

(Continued on page 2)

PHOENIX, ARIZONA  
2016 AUG 22 A 10:40  
RECEIVED  
BLM AZ STATE OFFICE

NW-V  
PB

|                               |                     |         |            |
|-------------------------------|---------------------|---------|------------|
| (Owner's Name - Please Print) | (Owner's Signature) |         |            |
| (Owner's Mailing Address)     | (City)              | (State) | (Zip Code) |
|                               |                     |         |            |
| (Owner's Name - Please Print) | (Owner's Signature) |         |            |
| (Owner's Mailing Address)     | (City)              | (State) | (Zip Code) |
|                               |                     |         |            |
| (Owner's Name - Please Print) | (Owner's Signature) |         |            |
| (Owner's Mailing Address)     | (City)              | (State) | (Zip Code) |
|                               |                     |         |            |
| (Owner's Name - Please Print) | (Owner's Signature) |         |            |
| (Owner's Mailing Address)     | (City)              | (State) | (Zip Code) |

18 U.S.C. 1001 and 43 U.S.C. 1212 make it a crime for any person knowingly and willfully to make to any department or agency of the United States any false, fictitious or fraudulent statements or representations as to any matter within its jurisdiction.

INSTRUCTIONS

1. This certification is made under the provisions of 43 U.S.C. § 1744 and 30 U.S.C. §28-28k and the regulations thereunder (43 CFR Part 3830).
2. The claimant(s) must fill in the dates in paragraph 1 for the beginning and ending of the assessment year for which this waiver is sought.
3. The claimant(s) must fill in the date in paragraph 2 for the beginning of the assessment year for which this waiver is sought.
4. All claim and site names and BLM serial numbers must be listed for the mining claims, mill sites, and tunnel sites for which the waiver is sought.
5. All owners of the mining claims, mill sites, and tunnel sites and their addresses must be given.
6. This waiver form must be signed by all the claimants or their designated agent, in original form. If an agent is designated, a notarized designation of agent, signed by all of the claimants with proper address given, must be submitted with this waiver.
7. This form must be filed no later than September 1st for the upcoming assessment year in the BLM State Office where the mining claims or sites are recorded, or the waiver cannot be granted by the BLM. (Example: To obtain a waiver for the assessment year 2012, which begins on September 1, 2011, you must qualify for and file for a waiver no later than September 1, 2011, in the proper BLM State Office.)
8. For all mining claims which require assessment work, you must record an affidavit of labor on or before the December 30th immediately following the filing of this waiver. For all other mining claims or sites waived, you must record a notice of intent to hold on or before the December 30th immediately following the filing of this waiver.
9. Mill and tunnel sites may also be listed on this waiver and be waived from payment of the maintenance fee. A notice of intent to hold for these sites is required to be filed by the December 30th following the filing of this waiver.

RECEIVED  
 BLM STATE OFFICE  
 PHOENIX, ARIZONA  
 AUG 22 A 10:40

FOR OFFICIAL USE ONLY

## NOTICES

**The Privacy Act** and 43 CFR 2.48(d) require that you be furnished the following information in connection with the information requested by this form.

**AUTHORITY:** 30 U.S.C. 28f and 43 CFR part 3835 permit collection of the information requested by this form.

**PRINCIPAL PURPOSE:** The BLM will use the information you provide to verify that the owner(s) (claimants(s)) of a mining claim has/have complied with 30 U.S.C. 28f and 43 CFR part 3835 and is/are entitled to perform assessment work in lieu of paying the maintenance fee for the mining claims listed on this form.

**ROUTINE USES:** The BLM will only disclose this information in accordance with the provisions at 43 CFR 2.56(b) and (c).

**EFFECT OF NOT PROVIDING INFORMATION:** Disclosure of the requested information is required by 30 U.S.C. 28f and 43 CFR part 3835 for those claimants qualified to request the small miner waiver allowed. Failure to submit all the requested information or to complete this form will delay the BLM's processing of the form and may preclude the BLM's acceptance of the maintenance fee waiver request, which may result in forfeiture of the mining claim or site by the claimant.

**The Paperwork Reduction Act** requires us to inform you that:

The BLM collects this information to determine whether or not you are qualified for waiver of maintenance fees.

Submission of the requested information is necessary to obtain or retain a benefit.

You do not have to respond to this or any other Federal agency-sponsored information collection unless it displays a currently valid OMB control number.

**BURDEN HOURS STATEMENT:** Public reporting burden for this form is estimated to average 20 minutes per response, including the time for reviewing instructions, gathering and maintaining data, and completing and reviewing the form. You may submit comments regarding the burden estimate or any other aspect of this form to: U.S. Department of the Interior, Bureau of Land Management (1004-0114), Bureau Information Collection Clearance Officer (WO-630), Mail Stop 401 LS, 1849 C St., N.W., Washington, D.C. 20240.

RECEIVED  
BLM AZ STATE OFFICE  
2016 AUG 22 A 10:40  
PHOENIX, ARIZONA



### Customer Name Update Screen

System ID:MC

Name: BREMER DONALD

Lookup

Proprietor #: 2365057

Renumber To:

Category: P - PRIVATE

Address: 9421 E MAIN ST LOT B47

City: MESA

State: AZ

Lookup

Zip: 852078899

UNDELIVERABLE

Email: DFB1945@YAHOO.COM

Phone: 660-890-5999

*Address Updated  
AC 170 per 2017 WVA  
ENTERED SEP 08 2016  
PB*

Save

Save/Override DataFlux

Delete

Renumber

Customer details successfully saved for Customer Id 2365057

### Customer Name Update Screen

System ID:MC

Name: PRICE GARY

Proprietor #: 2353143

Renumber To:

Category: P - PRIVATE

Address: 1363 N PLAZA DR

City: APACHE JUNCTION

State: AZ

Zip: 851202765

UNDELIVERABLE

Email:

Phone:

*Address Updated  
Ac 170 per 2017 WTR  
ENTERED SEP 08 2016  
PB*

Customer details successfully saved for Customer Id 2353143

**DEPARTMENT OF THE INTERIOR  
BUREAU OF LAND MANAGEMENT  
MINING CLAIMS**

**(LIVE) Serial Register Page**

Run Date/Time: 09/08/2016 07:21 AM

Page 1 of 1

**01 10-21-1976;090STAT0090;43USC1744**  
**Case Type 384201: PLACER CLAIM**  
**Claim Name: GOLDTIMERS**  
**Commodity :**  
**Case Disposition: ACTIVE**  
**Required Maintenance Fee: \$155.00**

**Total Acres**  
**20.000**

**Serial Number**  
**AMC429020**  
**Lead File Number**  
**AMC429020**

*AFTER ADDRESSES  
UPDATE*

| Name & Address |                        | Int Rel                                 |
|----------------|------------------------|---|
| BREMER DONALD  | 9421 E MAIN ST LOT B47 | MESA, AZ 85207-8899 CLAIMANT            |
| PRICE GARY     | 1363 N PLAZA DR        | APACHE JUNCTION, AZ 85120-2765 CLAIMANT |

| Mer Twp | Rng   | Sec   | Quadrant | District/Field Office | County  |
|---------|-------|-------|----------|-----------------------|---------|
| 14      | 0090N | 0050W | 025 NE   | HASSAYAMPA FO         | YAVAPAI |

| Act Date   | Code | Action                      | Action Remarks       | Receipt Number |
|------------|------|-----------------------------|----------------------|----------------|
| 09/02/2014 | 403  | LOCATION DATE               |                      |                |
| 09/03/2014 | 395  | RECORDATION NOTICE RECD     | 1                    | 3122111        |
| 08/22/2016 | 483  | SMALL MINER CERT FILED      | 2017                 |                |
| 09/01/2015 | 782  | MAINTENANCE FEE PAYMENT     | 2016;\$155           | 3383070        |
| 08/22/2016 | 480  | EVID OF ASSMT FILED         | 2016                 | 3636723        |
| 09/03/2014 | 484  | LOCATION YEAR / MAINTENANCE | 2015;\$155           | 3122111        |
| 08/22/2016 | 170  | ADDRESS CHANGE FILED        | D BREMER & G PRICE ✓ |                |
| 06/05/2015 | 635  | AMENDED LOCATION FILED      | REDUCE LENGTH        | 3314756        |
| 05/13/2015 | 393  | DECISION/NOTICE ISSUED      | AMENDMENT REQUIRED   |                |
| 05/04/2015 | 669  | LAND STATUS CHECKED         |                      |                |
| 09/03/2014 | 501  | ACCT ADV IN LEAD FILE       | AMC429020;           |                |
| 09/03/2014 | 685  | ADDL MAINTENANCE FEE        | 2015;\$155           | 3122111        |

Line Nr Remarks

**DEPARTMENT OF THE INTERIOR  
BUREAU OF LAND MANAGEMENT  
MINING CLAIMS**

Run Date/Time: 09/08/2016 07:10 AM

**(LIVE) Serial Register Page**

Page 1 of 1

**01 10-21-1976;090STAT0090;43USC1744**  
**Case Type 384201: PLACER CLAIM**  
**Claim Name: GOLDTIMERS**  
**Commodity :**  
**Case Disposition: ACTIVE**  
**Required Maintenance Fee: \$155.00**

**Total Acres**  
**20.000**

**Serial Number**  
**AMC429020**  
**Lead File Number**  
**AMC429020**

**Name & Address**

|               |                            |                                |          |
|---------------|----------------------------|--------------------------------|----------|
| PRICE GARY    | 1325 N DELAWARE DR LOT 134 | APACHE JUNCTION, AZ 85120-2567 | CLAIMANT |
| BREMER DONALD | 1325 N DELAWARE DR LOT 134 | APACHE JUNCTION, AZ 85120-2567 | CLAIMANT |

*PREVIOUS ADDRESSES*

**Int Rel**

|                        |                 |                              |               |
|------------------------|-----------------|------------------------------|---------------|
| <b>Mer Twp Rng Sec</b> | <b>Quadrant</b> | <b>District/Field Office</b> | <b>County</b> |
| 14 0090N 0050W 025     | NE              | HASSAYAMPA FO                | YAVAPAI       |

| <b>Act Date</b> | <b>Code</b> | <b>Action</b>               | <b>Action Remarks</b> | <b>Receipt Number</b> |
|-----------------|-------------|-----------------------------|-----------------------|-----------------------|
| 09/02/2014      | 403         | LOCATION DATE               |                       |                       |
| 09/03/2014      | 395         | RECORDATION NOTICE RECD     | 1                     | 3122111               |
| 09/01/2015      | 782         | MAINTENANCE FEE PAYMENT     | 2016;\$155            | 3383070               |
| 08/22/2016      | 480         | EVID OF ASSMT FILED         | 2016                  | 3636723               |
| 09/03/2014      | 484         | LOCATION YEAR / MAINTENANCE | 2015;\$155            | 3122111               |
| 06/05/2015      | 635         | AMENDED LOCATION FILED      | REDUCE LENGTH         | 3314756               |
| 05/13/2015      | 393         | DECISION/NOTICE ISSUED      | AMENDMENT REQUIRED    |                       |
| 05/04/2015      | 669         | LAND STATUS CHECKED         |                       |                       |
| 09/03/2014      | 501         | ACCT ADV IN LEAD FILE       | AMC429020;            |                       |
| 09/03/2014      | 685         | ADDL MAINTENANCE FEE        | 2015;\$155            | 3122111               |

**Line Nr Remarks**

**NO WARRANTY IS MADE BY BLM  
FOR USE OF THE DATA FOR  
PURPOSES NOT INTENDED BY BLM**

\_\_\_\_\_  
 \_\_\_\_\_  
 \_\_\_\_\_

428306  
 429019  
 429020  
 433685

Check here is this is a change of address.

Telephone: \_\_\_\_\_

E-mail address: \_\_\_\_\_

**AFFIDAVIT OF PERFORMANCE OF ANNUAL WORK**

1. State of Arizona, County of Yavapai ss:
2. I (Name) Ronald F Bremer
3. Reside at (Address) 9421 E Main ST #1047

RECEIVED  
 BLM AZ STATE OFFICE  
 2016 AUG 22 A 10:55  
 PHOENIX, ARIZONA  
 BLM  
 Date  
 Stamp

City Mesa County Maricopa

State AZ Zip 85207 being duly sworn, depose and say that I am a citizen of the United States, more than eighteen years of age, and that all of the facts set forth in this affidavit, subject to the provisions and penalties of 18 U.S.C. 1001 pertaining to the filing of false, fictitious, or fraudulent statements with the United States, are true and correct according to the best of my knowledge, information and belief.

4. Owner's name and address (if not shown in items 1-3 above) \_\_\_\_\_

5. That I am personally acquainted with the mining claim(s). The work and improvements were made by and at the expense of the owner(s) of said claim(s). Said contiguous group of claims, listed on this document, are situated in the

\_\_\_\_\_ (optional) Mining District; \_\_\_\_\_ County, Arizona.

| Line No. | AMC NUMBER | CLAIM/SITE NAME | COUNTY RECORDER DATA (If available) | TWP | RNG | SEC |
|----------|------------|-----------------|-------------------------------------|-----|-----|-----|
| 1        | 429020     | Gold Timers     | Yavapai                             |     |     |     |
| 2        | 433685     | Gold Timers #2  | Yavapai                             |     |     |     |
| 3        | 428306     | Gold Timers #3  | Yavapai                             |     |     |     |
| 4        | 429019     | Gold Timers #4  | Yavapai                             |     |     |     |
| 5        |            |                 |                                     |     |     |     |
| 6        |            |                 |                                     |     |     |     |

RECEIVED  
BLM AZ STATE OFFICE  
2016 AUG 22 A 10:55  
PHOENIX, ARIZONA  
BLM  
Date  
Stamp

|    |  |  |  |  |  |
|----|--|--|--|--|--|
| 7  |  |  |  |  |  |
| 8  |  |  |  |  |  |
| 9  |  |  |  |  |  |
| 10 |  |  |  |  |  |

6. That between the dates starting at 12 o'clock noon on September 1, 20 15 and ending at 12 o'clock noon on September 1, 20 16 at least \$ 400.00 dollars worth of work and improvements were done and performed upon said claim(s) or upon one or more of a contiguous group of claims for the benefit of all, wholly or partly outside of a contiguous group of claims for the benefit of all, not including the location work.

7. That the following persons were employed to perform the work and improvements described herein: \_\_\_\_\_

Donald Bremner Gary Price

8. That the work and improvements performed were: road work where it was washed out @ \$20.00 - 20 hrs  
watch man \$10.00 - 40 hrs

9. Dated: 8-22-2016 Signature: Donald Bremner

SUBSCRIBED AND SWORN TO before me, a Notary Public, this 22<sup>nd</sup> day of August 20 16

By: Donald F. Bremner

Notary Public [Signature]  
My Commission Expires 3/27/2020

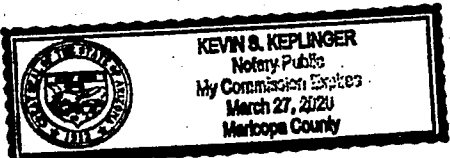

Bureau of Land Management  
Arizona State Office  
[www.blm.gov/az](http://www.blm.gov/az)

No. of Claims: 4 x \$10 = 400  
Check No.: CASH Init. PER  
Receipt No.: \_\_\_\_\_  
For BLM Use Only

**United States Department of the Interior**  
**Bureau of Land Management**  
 DIV OF LANDS, MINRLS & ENERGY  
 ONE N CENTRAL AVE  
 PHOENIX, AZ 85004 -4427  
 Phone: 602-417-9200

Receipt

No: 3636723

|   |  |
|---|--|
| <b>Transaction #:</b> 3740592                                     |  |
| <b>Date of Transaction:</b> 08/22/2016                            |  |
| <b>CUSTOMER:</b>  |  |
| DONALD BREMER<br>9421 E MAIN ST<br>#B47<br>MESA, AZ 85207-8822 US |  |

| LINE #        | QTY  | DESCRIPTION   | REMARKS          | UNIT PRICE | TOTAL          |
|---------------|------|---|------------------|------------|----------------|
| 1             | 1.00 | LOCATABLE MINERALS / MINING CLAIMS- NOT NEW-UNADJUD, ONE AUTH NO. ONLY / MINING CLAIM MONEY RECEIVED<br><b>CASES: AMC429020/\$40.00</b> | 2016 AFFADAVIT/4 | - n/a -    | 40.00          |
| <b>TOTAL:</b> |      |   |                  |            | <b>\$40.00</b> |

| PAYMENT INFORMATION |         |   |             |            |  |
|---------------------|---------|---|-------------|------------|--|
| 1                   | AMOUNT: | 40.00   | POSTMARKED: | N/A        |  |
|                     | TYPE:   | CASH  | RECEIVED:   | 08/22/2016 |  |
|                     | NAME:   | BREMER, DONALD<br>9421 E MAIN ST<br>#B47<br>MESA AZ 85207-8822 US |             |            |  |

|         |
|---------|
| REMARKS |
|         |

This receipt was generated by the automated BLM Collections and Billing System and is a paper representation of a portion of the official electronic record contained therein.

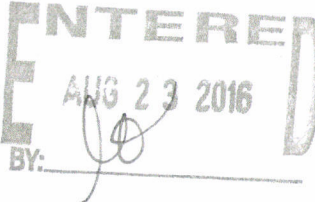
  
 ENTERED  
 AUG 23 2016  
 BY: *[Signature]*

429020

**MAINTENANCE FEE PAYMENT**

Claimant Name: Donald Bremer  
Address: 1325 N. Delaware Dr #134  
City: Apache Junction State: AZ Zip: 85120  
Telephone: 602990-5999  
E-mail address: DFB1945@yahoo.com  
Signature: Donald J Bremer

|   |                      |
|---|----------------------|
| RECEIVED<br>BLN AZ STATE OFFICE<br>2015 SEP - 1 A 9: 26<br>PHOENIX, ARIZONA | BLM<br>Date<br>Stamp |
|---|----------------------|

Check here if this is a change of address.

| LINE NO. | AMC NUMBER | CLAIM/SITE NAME | COUNTY RECORDER DATA (If available) | TWP | RNG | SEC |
|----------|------------|-----------------|-------------------------------------|-----|-----|-----|
| 1        | 429020     | Gold Timers     |                                     |     |     |     |
| 2        |            |                 |                                     |     |     |     |
| 3        |            |                 |                                     |     |     |     |
| 4        |            |                 |                                     |     |     |     |
| 5        |            |                 |                                     |     |     |     |
| 6        |            |                 |                                     |     |     |     |
| 7        |            |                 |                                     |     |     |     |
| 8        |            |                 |                                     |     |     |     |
| 9        |            |                 |                                     |     |     |     |
| 10       |            |                 |                                     |     |     |     |

List additional claims on Form MCF114.

**Bureau of Land Management**  
**Arizona State Office**  
[www.blm.gov/az/](http://www.blm.gov/az/)

|  |
|--|
| No. of Claims*: <u>1</u> x \$155 = <u>155</u><br>Check No: <u>Cash</u> Init. <u>JMB</u><br>Receipt No.: <u>13383070</u><br><b>For BLM Use Only</b> |
|--|

\* \$155 per lode mining claim, mill site, or tunnel site; and \$155 for each 20 acres or portion thereof for each placer mining claim.

**Form: MCF112**  
Revised July 2014

ENTERED  
 SEP 03 2015  
 BY: ll

This form is available from the **Arizona Geological Survey** and may be reproduced.



**United States Department of the Interior**  
**Bureau of Land Management**  
 LANDS/RECREATION & PLANNING  
 ONE N CENTRAL AVE  
 PHOENIX, AZ 85004 -2203  
 Phone: 602-417-9200

Receipt

No: 3383070

|  |  |
|--|--|
| <b>Transaction #:</b> 3481386  |  |
| <b>Date of Transaction:</b> 09/01/2015   |  |
| <b>CUSTOMER:</b>   |  |
| DONALD BREMER<br>1325 N DELAWARE DR LOT 134<br>APACHE JUNCTION, AZ 85120-2567 US |  |

| LINE #        | QTY  | DESCRIPTION  | REMARKS         | UNIT PRICE | TOTAL           |
|---------------|------|--|-----------------|------------|-----------------|
| 1             | 1.00 | LOCATABLE MINERALS / MINING CLAIMS-<br>NOT NEW-UNADJUD, ONE AUTH NO. ONLY /<br>MINING CLAIM MONEY RECEIVED<br><b>CASES: AMC429020/\$155.00</b> | MAINT<br>2016/1 | - n/a -    | 155.00          |
| <b>TOTAL:</b> |      |  |                 |            | <b>\$155.00</b> |

| PAYMENT INFORMATION |         |  |             |            |  |
|---------------------|---------|--|-------------|------------|--|
| 1                   | AMOUNT: | 155.00   | POSTMARKED: | N/A        |  |
|                     | TYPE:   | CASH   | RECEIVED:   | 09/01/2015 |  |
|                     | NAME:   | BREMER, DONALD<br>1325 N DELAWARE DR LOT 134<br>APACHE JUNCTION AZ 85120-2567 US |             |            |  |

|         |
|---------|
| REMARKS |
|         |

This receipt was generated by the automated BLM Collections and Billing System and is a paper representation of a portion of the official electronic record contained therein.

**ENTERED**  
 SEP 03 2015  
 BY: *[Signature]*

**NOTICE!!**

**These documents have been scanned!**

**Do not place un-scanned documents beneath this notice!**

**Do not remove this notice from this file!**

GPO Jacket No. 560-102  
Print Order 61540  
Rise Business Services, LLC  
Job=AZ15 5/10/2019



Box Number= AZ15032



Claim Begin-End: AMC429020-AMC429020

5 Miscellaneous



AZ15032-9

AMC428906-AMC429539

**United States Department of the Interior**  
**Bureau of Land Management**  
 LANDS/RECREATION & PLANNING  
 ONE N CENTRAL AVE  
 PHOENIX, AZ 85004 -2203  
 Phone: 602-417-9200

Receipt

No: 3314756

|  |  |
|--|--|
| <b>Transaction #:</b> 3411898  |  |
| <b>Date of Transaction:</b> 06/05/2015   |  |
| CUSTOMER:  |  |
| DONALD BREMER<br>1325 N DELAWARE DR LOT 134<br>APACHE JUNCTION, AZ 85120-2567 US |  |

| LINE #        | QTY  | DESCRIPTION   | REMARKS    | UNIT PRICE | TOTAL          |
|---------------|------|---|------------|------------|----------------|
| 1             | 1.00 | LOCATABLE MINERALS / MINING CLAIMS-<br>NOT NEW-UNADJUD, ONE AUTH NO. ONLY /<br>MINING CLAIM MONEY RECEIVED<br><b>CASES:</b> AMC429020/\$10.00 | AMEND<br>1 | - n/a -    | 10.00          |
| <b>TOTAL:</b> |      |   |            |            | <b>\$10.00</b> |

| PAYMENT INFORMATION |         |  |                      |
|---------------------|---------|--|----------------------|
| 1                   | AMOUNT: | 10.00  | POSTMARKED: N/A      |
|                     | TYPE:   | CASH   | RECEIVED: 06/05/2015 |
|                     | NAME:   | BREMER, DONALD<br>1325 N DELAWARE DR LOT 134<br>APACHE JUNCTION AZ 85120-2567 US |                      |

|         |
|---------|
| REMARKS |
|         |

This receipt was generated by the automated BLM Collections and Billing System and is a paper representation of a portion of the official electronic record contained therein.

**ENTERED**  
 635  
 JUN 10 2015  
 BY: *[Signature]*

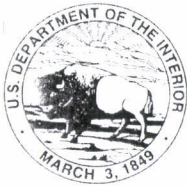

# United States Department of the Interior



BUREAU OF LAND MANAGEMENT

Arizona State Office

One North Central Avenue, Suite 800

Phoenix, Arizona 85004-4427

www.blm.gov/az/

**MAY 13 2015**

In Reply Refer To:  
3800 (9310) RM  
AMC429020

CERTIFIED MAIL - RETURN RECEIPT REQUESTED No. 7014 0150 0000 5453 6780

## NOTICE

DONALD BREMER :  
1325 N DELAWARE DR LOT 134 :  
APACHE JUNCTION, AZ 85120-2567 :

This Notice Affects the Claims  
Shown in the Block Below.

---

AMC429020  
GOLDTIMERS

---

### Mining Claim Location Notice(s) – Amendment(s) Required

Pursuant to Title 43 Code of Federal Regulations (CFR) 3832.1, the Bureau of Land Management (BLM), Arizona State Office, received your notices of location for recording mining claims. In accordance with 43 CFR 3832.12, the claims listed above cannot be accepted as filed and must be amended as noted below.

The claim is an excess length. A placer claim with two owners cannot exceed 1320 feet in length. Your claim is 2640 feet in length. You must reduce the length of your claim from 2640 feet to 1320 feet. You may not take in new ground through an amendment.

When amending a claim, you cannot take in any new ground. Amending the claim may result in a claim that contains significantly less acreage than was originally located. If you wish to retain the same acreage, you may want to relocate the claim(s) correctly, rather than amend the incorrectly located claim(s).

You must file an amendment for each claim listed above to correct the defects identified. There is a \$10 BLM processing fee for each amendment. We must receive the amendments within 30 days of your receipt of this notice. If the amendments are not received within the 30 day timeframe the mining claims will be declared null and void.

If additional information is required, please contact RéAnn Myers at 602-417-9413. Please include your AMC serial number(s) on all correspondence.

Sincerely,

*Michael J Werner*  
for

Rebecca Heick  
Acting Deputy State Director  
Lands & Minerals Division

Enclosure(s)

U.S. Department of the Interior  
Bureau of Land Management  
Arizona State Office

|   |   |                                |                         |
|---|---|--------------------------------|-------------------------|
| <b>CONVERSATION RECORD</b>  |   | Time<br><i>11:00 AM</i>        | Date<br><i>4/1/2015</i> |
| Type<br><input type="checkbox"/> Visit <input type="checkbox"/> Conference <input checked="" type="checkbox"/> Telephone<br><span style="float: right;"><input type="checkbox"/> Incoming<br/><input checked="" type="checkbox"/> Outgoing</span> |   |                                |                         |
| Location of Visit/Conference  |   |                                |                         |
| Name of Person(s) Contacted or in Contact With You<br><i>GARY PRICE</i>   | Organization (Office, Dept., Bureau, etc.)<br><i>AMC 429019 / <del>AMC 429020</del></i> | Telephone<br><i>AME 429620</i> |                         |
| Subject   |   |                                |                         |

*ADDRESS*

Summary

*PHONED GARY PRICE TO UPDATE/VERIFY ADDRESS ON FILE.  
HE STATED HIS CURRENT MAILING ADDRESS IS:  
1325 N. DELAWARE DR. LOT 132  
APACHE JUNCTION, AZ 85120*

Action Required *UPDATED LR2000 ON 4/1/2015*

|  |   |                         |
|--|---|-------------------------|
| Name of Person Documenting Conversation<br><i>RE ANN MYERS</i> | Signature<br> | Date<br><i>4/1/2015</i> |
|--|---|-------------------------|

Action Taken

|           |       |      |
|-----------|-------|------|
| Signature | Title | Date |
|-----------|-------|------|

**NOTICE!!**

**These documents have been scanned!**

**Do not place un-scanned documents beneath this notice!**

**Do not remove this notice from this file!**

GPO Jacket No. 560-102  
Print Order 61540  
Rise Business Services, LLC  
Job=AZ15 5/10/2019



Box Number= AZ15032



Claim Begin-End: AMC429020-AMC429020

6 Location Notices-Amendments and Supporting Documents



AZ15032-9

AMC428906-AMC429539

**M...ING CLAIM STATUS REPORT**

Data Entered: 09/15/14 RAM

MTP Checked By: DC  
GEO Checked By: AC

LEAD SERIAL NUMBER: AMC 429020 thru AMC \_\_\_\_\_

**NUMBER OF CLAIMS & TYPE:**

\_\_\_\_ LODGE  
1 PLACER  
\_\_\_\_ ASSOCIATION PLACER  
\_\_\_\_ MILL SITE  
\_\_\_\_ TUNNEL SITE

**CHARGES:**

Location Fee @ \$37 = \$ 37  
Processing Fee @ \$20 = \$ 20  
Maintenance Fee @ \$155 = \$ 155  
Add'l Maint Fee for Assoc Placer = \$ 155  
**SUBTOTAL** \$ \_\_\_\_\_  
Other Fees \$ \_\_\_\_\_  
Other Fees \$ \_\_\_\_\_  
**TOTAL** \$ 367

TOTAL ACREAGE: 40 Per Claim  
(Placer Only)

NUMBER OF LOCATORS: 2

DOCUMENTS RECEIVED VIA : Over-the-Counter [] Mail [ ] **TIMELY FILED:** Yes [] No [ ]

LEGAL DESCRIPTION: T 9N R 5W SEC 25  
T \_\_\_\_\_ R \_\_\_\_\_ SEC \_\_\_\_\_  
T \_\_\_\_\_ R \_\_\_\_\_ SEC \_\_\_\_\_  
T \_\_\_\_\_ R \_\_\_\_\_ SEC \_\_\_\_\_  
T \_\_\_\_\_ R \_\_\_\_\_ SEC \_\_\_\_\_

BLM [] FOREST SERVICE [ ] \_\_\_\_\_ SUBJ TO PL 359: Yes [ ] No [ ]  
WILDERNESS AREA [ ] \_\_\_\_\_

SPLIT ESTATE: N/A [ ] SX [ ] PX [ ] OTHER [ ] \_\_\_\_\_  
SRHA [ ] Was proper Notice filed if located on SHRA Land? Yes [ ] No [ ]

**RECONVEYED MINERALS ON BLM LAND REQUIRE OPENING ORDER FROM 1944 TO 1993:**

Open to Entry On \_\_\_\_\_ N/A [ ]

COMMENTS/STATUS: VOID [ ] PARTIALLY VOID [ ] PVT MINERALS [ ] WITHDRAWN LANDS [ ]  
OTHER [ ] \_\_\_\_\_

[ ] Claimant acknowledges that portions of the following claim(s) site(s) may be void or voidable.

Printed Name of Claimant \_\_\_\_\_ Signature of Claimant \_\_\_\_\_

\*\*\*\*\*FINAL ADJUDICATION\*\*\*\*\*

DATE 5-4-2015 INITIALS RM

AMC 429020



LOCATION NOTICE FOR PLACER MINING CLAIM

Amendment BLM Serial # AMC429020

NOTICE IS HEREBY GIVEN that the Gold timers

\_\_\_\_\_ placer mining claim has been located by

Donald Bremer whose current mailing

address is 1325 N. Delaware Dr

Site 134 Apache Junction, AZ 85120

BLM  
Date  
Stamp

RECEIVED  
AZ STATE OFFICE  
2015 JUN -5 A 9: 29  
PHOENIX, ARIZONA

The general course of this claim is West & South and it is situated in Yavapai

County, Arizona. This claim is 1320 feet in length and 660 feet in width.

20 Total Claim Acreage. This claim runs from the location monument on which this location notice is posted at the NE corner of the claim approximately 660 feet in a west direction to the NW end line and 1320 feet in a South direction to the SE end line. This claim is marked by four monuments, one at each corner of the claim.

The location monument on which this notice is posted is situated within Section 25, Township

9 N, Range 5 W, Gila Salt River Base and Meridian, Arizona. This claim encompasses portions of the following legal subdivision(s) if located by legal subdivision or the following quarter section(s),

section(s), Township(s) and Range(s) NE 1/4 Section 25 T4N 9N

Range 5 W, Gila Salt River Base and Meridian, Arizona.

The locality of this claim with reference to some natural object or permanent monument and additional information

(if any) concerning its locality are as follows: The NE corner is located 1320 ft.

South of Perm Brass Marker for Section 24 & 25 9N and sections 19 & 30 9N 4W The above information is shown on the attached map.

Gila Salt River Base & Meridian AZ  
DATED AND POSTED on the ground this 5 day of June, 2015 Amendment

LOCATOR(s)  AGENT

Print Name(s) Donald Bremer GARY PRICE

Signature(s) Donald Bremer GARY PRICE

Form MCF102  
Revised July 2014

AMC 429020

**MINING CLAIM MAP**

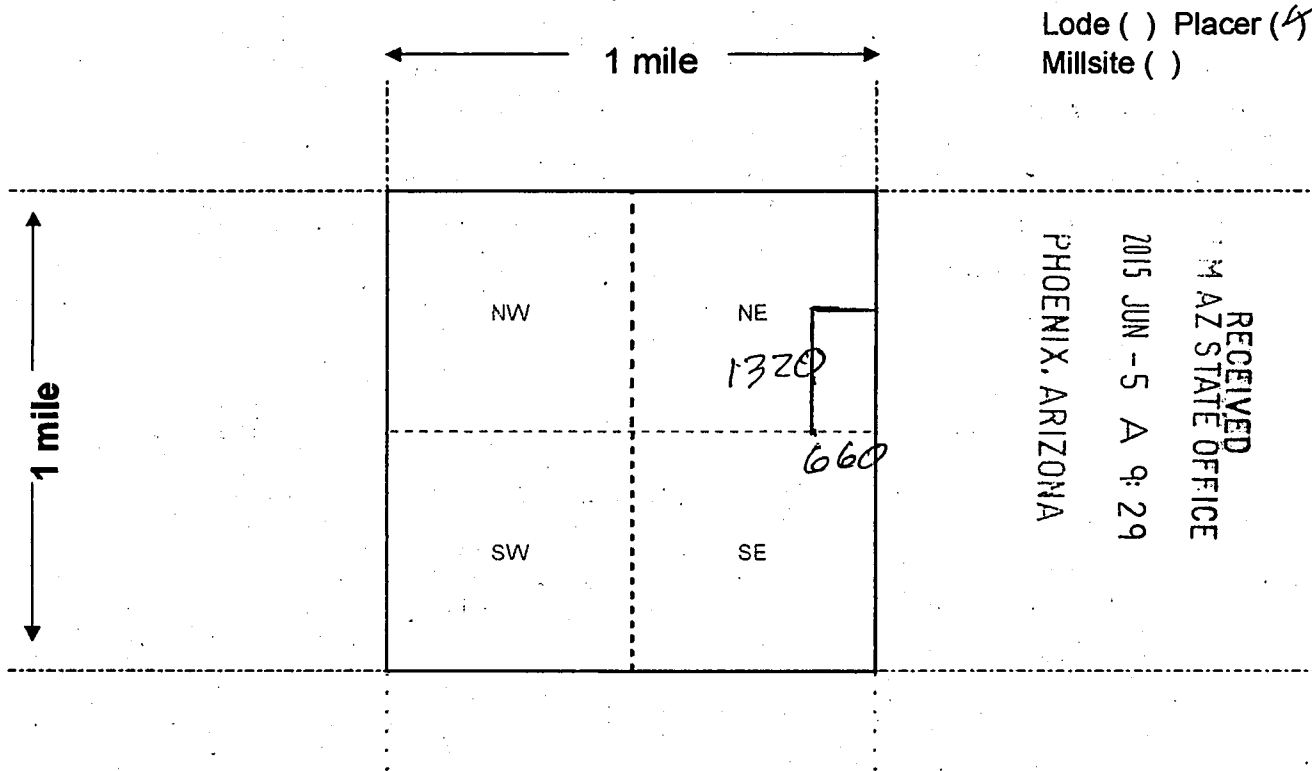

Scale: 1" = 2000 feet



1. The above map depicts the \_\_\_\_\_ mining claim, which is located in Section (s) 25, Township 9 N, Range 5 W, Gila and Salt River Base and Meridian, Yavapai County, Arizona. Total claim acreage is 20
2. The type of corner and location monuments used are as follows: White PVC Pipe 5 ft Tall
3. The bearings and distances in degrees and feet between claim corners and to a public land survey monument are as depicted on the map.
4. If the claim is a placer or millsite claim with exterior limits conforming to legal subdivisions of the public survey, provide a legal description of the claim \_\_\_\_\_

**Form MCF100a**  
Revised July 2014

RECEIVED  
BLM AZ STATE OFFICE  
2014 SEP - 3 P 2:34  
PHOENIX, AZ

**LOCATION NOTICE FOR PLACER MINING CLAIM**

Amendment BLM Serial # \_\_\_\_\_

NOTICE IS HEREBY GIVEN that the Goldtimers  
\_\_\_\_\_ placer mining claim has been located by

BLM  
Date  
Stamp

Donald Bremer whose current mailing  
address is 1325 N. Delaware Dr.

Site 134 Apache Junction, AZ-85120

The general course of this claim is West + South and it is situated in Yavapai  
County, Arizona. This claim is 2640 feet in length and 660 feet in width.

40 Total Claim Acreage. This claim runs from the location monument on which this location notice is  
posted at the NE corner of the claim approximately 660 feet in a West direction to the  
NW end line and 2640 feet in a South direction to the SE end line. This claim is  
marked by four monuments, one at each corner of the claim.

The location monument on which this notice is posted is situated within Section 25, Township  
9 N, Range 5 W, Gila Salt River Base and Meridian, Arizona. This claim encompasses

portions of the following legal subdivision(s) if located by legal subdivision or the following quarter section(s),  
section(s), Township(s) and Range(s) NE 1/4 Section 25 T19N 9N  
Range 5 W, Gila Salt River Base and Meridian, Arizona.

The locality of this claim with reference to some natural object or permanent monument and additional information  
(if any) concerning its locality are as follows: The NE corner is Perm. Brass Marker  
for Sections 24 & 25 9N and Sections 19 & 30 9N 4W  
Gila Salt River Base & Meridian AZ The above information is shown on the attached map.

DATED AND POSTED on the ground this 02 day of September, 2014.

LOCATOR(s)  AGENT

Print Name(s) Donald Bremer Gary Price

Signature(s) Donald Bremer Gary Price

Form MCF102  
Revised July 2014

AMC 4290201

**MINING CLAIM MAP**

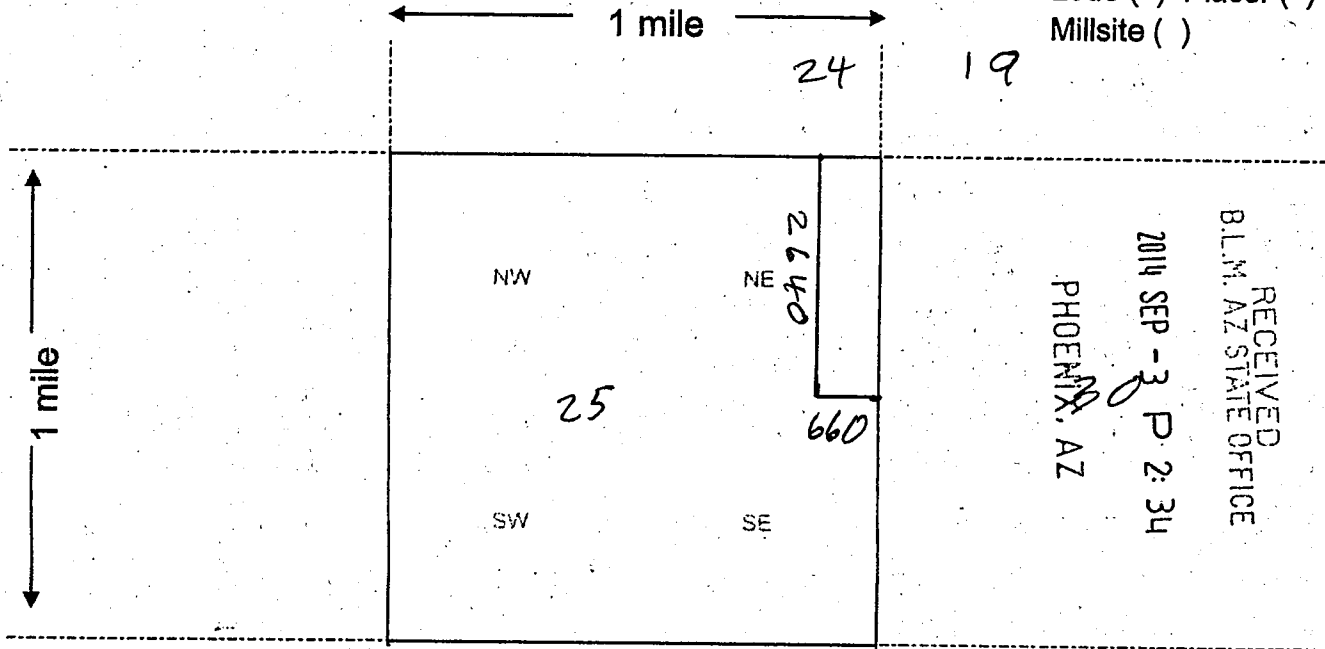

AMC 429020

Scale: 1" = 2000 feet



1. The above map depicts the Goldtimers mining claim, which is located in Section (s) 25, Township 9 N, Range 5 W, Gila and Salt River Base and Meridian, Yavapai County, Arizona. Total claim acreage is 40
2. The type of corner and location monuments used are as follows: white PVC Pipe 5 ft Tall
3. The bearings and distances in degrees and feet between claim corners and to a public land survey monument are as depicted on the map.
4. If the claim is a placer or millsite claim with exterior limits conforming to legal subdivisions of the public survey, provide a legal description of the claim \_\_\_\_\_

Form MCF100a  
Revised July 2014

UNITED STATES DEPARTMENT OF THE INTERIOR  
BUREAU OF LAND MANAGEMENT  
LIST OF MINING CLAIMS BY SECTION

MTRS: 14 0090N 0050W 025

| <u>Serial Number</u> | <u>Quad</u> | <u>Claim Name</u>    | <u>Claimant</u>       | <u>Lead File</u> | <u>Case Type</u> | <u>Status</u> | <u>Loc Date</u> | <u>Last Assmt</u> |
|----------------------|-------------|----------------------|-----------------------|------------------|------------------|---------------|-----------------|-------------------|
| AMC390176            | SW          | AH #23               | ORO GRANDE MINING LLC | AMC390154        | 384201           | ACTIVE        | 02/18/2008      | 2015              |
| AMC390177            | SW          | AH #24               | MEYER ALLAN J         | AMC390154        | 384201           | ACTIVE        | 02/18/2008      | 2015              |
| AMC406337            | SW          | GOLD BAR             | ASTERION MINERALS LLC | AMC406336        | 384201           | ACTIVE        | 12/21/2010      | 2015              |
| AMC409629            | NE          | SIMPLEX              | ASTERION MINERALS LLC | AMC409628        | 384201           | ACTIVE        | 07/21/2011      | 2015              |
| AMC409630            | SW          | SIMPLEX 2            | ASTERION MINERALS LLC | AMC409628        | 384201           | ACTIVE        | 07/21/2011      | 2015              |
| AMC418633            | NW          | RED SOLO CUP         | CURRY ANTHONY L       | AMC418633        | 384201           | ACTIVE        | 11/01/2012      | 2015              |
|                      | NW          |                      | GENTRY DANIEL         | AMC418633        | 384201           | ACTIVE        | 11/01/2012      | 2015              |
| 118635               | NW          | DREAM CATCHER        | SELBERG LARRY         | AMC418635        | 384201           | ACTIVE        | 10/25/2012      | 2015              |
| +18698               | NW          | BILLIE R             | COULTER BILL          | AMC418698        | 384201           | ACTIVE        | 11/16/2012      | 2015              |
|                      | NW          |                      | RUCKER BILLIE         | AMC418698        | 384201           | ACTIVE        | 11/16/2012      | 2015              |
|                      | NW          |                      | SELBERG LARRY         | AMC418698        | 384201           | ACTIVE        | 11/16/2012      | 2015              |
| AMC426811            | NW          | GOLDEN TRIANGLE      | PIETRUSZKA RICHARD    | AMC426808        | 384201           | ACTIVE        | 02/07/2014      | 2015              |
|                      | NW          |                      | VROOMAN MELBURN N     | AMC426808        | 384201           | ACTIVE        | 02/07/2014      | 2015              |
| AMC426812            | NW          | GOLDEN TRIANGLESOUTH | PIETRUSZKA RICHARD    | AMC426808        | 384201           | ACTIVE        | 02/07/2014      | 2015              |
|                      | NW          |                      | VROOMAN MELBURN N     | AMC426808        | 384201           | ACTIVE        | 02/07/2014      | 2015              |
| AMC427434            | NE          | STOCKMYER NORTH      | POSEY MARY            | AMC427434        | 384201           | ACTIVE        | 02/26/2014      | 2014              |
|                      | NE          |                      | POSEY RONALD          | AMC427434        | 384201           | ACTIVE        | 02/26/2014      | 2014              |
| AMC427435            | NW          | STOCKMYER NORTH EXT  | POSEY MARY            | AMC427434        | 384201           | ACTIVE        | 02/26/2014      | 2014              |
|                      | NW          |                      | POSEY RONALD          | AMC427434        | 384201           | ACTIVE        | 02/26/2014      | 2014              |
| AMC427436            | NE          | STOCKMYER SOUTH      | POSEY MARY            | AMC427434        | 384201           | ACTIVE        | 02/26/2014      | 2014              |
|                      | NE          |                      | POSEY RONALD          | AMC427434        | 384201           | ACTIVE        | 02/26/2014      | 2014              |
| AMC427437            | NW          | STOCKMYER SOUTH EXT  | POSEY MARY            | AMC427434        | 384201           | ACTIVE        | 02/26/2014      | 2014              |
|                      | NW          |                      | POSEY RONALD          | AMC427434        | 384201           | ACTIVE        | 02/26/2014      | 2014              |
| AMC428306            | SE          | GOLDTIMERS # 3       | BREMER DONALD         | AMC428306        | 384201           | ACTIVE        | 06/07/2014      | 2014              |

